

SEAL TOOLS

SEAL & PINION PULLERS

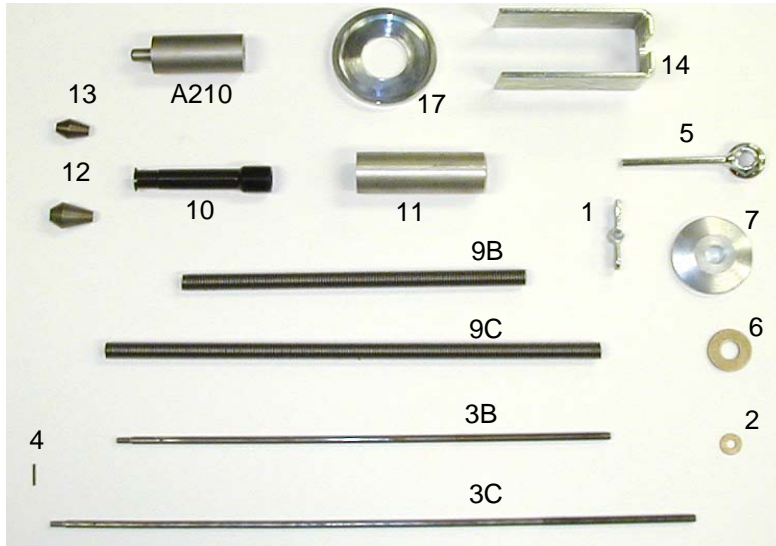

| DIAGRAM NO | AS REF | DESCRIPTION |
|------------|---------|--|
| 1 | AS14174 | Puller wing nut, 5/16-18" |
| 2 | AS14175 | 5/16", thrust washer |
| 3B | AS14177 | Inner threaded rod, 16" |
| 3C | AS14178 | Inner threaded rod, 21" |
| 4 | AS14179 | 5/64" x 3/4", spring pin |
| 5 | AS14180 | Clamp assembly, 5/8"-11 |
| 6 | AS14181 | 5/8", hardened thrust washer |
| 7 | AS14182 | Wheel plate |
| 9B | AS14184 | Threaded rod, 11" |
| 9C | AS14185 | Threaded rod, 16" |
| 10 | AS12816 | Puller fingers |
| 11 | AS14187 | Aluminium puller shield |
| 12 | AS14188 | 1" puller spreader, Ford Explorer |
| 13 | AS14186 | 3/4" puller spreader |
| 76B | AS14189 | Seal puller complete, 17" |
| 76C | AS12556 | Seal puller complete, 22" |
| 14 | AS14191 | Puller frame |
| 17 | AS14194 | Puller base |
| A210 | AS14199 | Audi, main seal remover, requires handle no 21 for use |

SEAL SAVERS

SEAL TOOLS



| DIAGRAM NO | AS REF | DESCRIPTION |
|------------|---------|--|
| 25 | AS14200 | Pinion seal bullet, 0.800" O/D |
| 26 | AS14201 | Pinion seal bullet, 0.865" O/D |
| 32 | AS14202 | Inner seal sleeve, 1.125" I/D |
| 33 | AS14203 | Inner seal starter plug, 1.125" O/D |
| 56 | AS14205 | TRW, Escort, CAM, VW type inner seal tube sleeve, 0.875" I/D |
| 57 | AS14206 | Bulkhead seal bullet, 0.904" O/D |
| 63 | AS14207 | Inner seal sleeve, 0.985" I/D |
| 64 | AS14208 | Inner seal starter plug, 0.985" O/D |
| 72 | AS14209 | Bulkhead seal bullet, 0.985" O/D |
| A230 | AS14210 | Audi, bullet tool |
| 78 | AS14211 | Early J car, bullet tool |
| 102 | AS14212 | Late J car, bullet tool |
| 110 | AS14213 | Late Ford, GM, BMW main casting seal tube sleeve, 0.982" I/D |
| 111 | AS14214 | Ford Escort, Tempo main casting seal tube sleeve, 0.908" I/D |
| 112 | AS14215 | Peugeot, Winnebago main casting seal tube sleeve |

TEFLON RING RESIZERS

SEAL TOOLS



| DIAGRAM NO | AS REF | DESCRIPTION |
|------------|---------|--|
| 37 | AS14244 | TRW, CAM and Ford piston, 1.495" I/D |
| 38 | AS14245 | Cast iron Ford pinion and piston, 1.625" I/D |
| 39 | AS14246 | Ford pinion, 1.515" I/D |
| 40 | AS14247 | Ford , TRW, CAM piston, 1.625" I/D |
| 58 | AS14248 | GM Saginaw piston, 1.682" I/D |
| 60 | AS14250 | Chrysler, GM Saginaw piston, 1.570" I/D |
| 61 | AS14251 | Saginaw pinion, 1.470" I/D |
| 62 | AS14252 | TRW, CAM small bore pinion, 1.180" I/D |
| 113 | AS15899 | Dodge Ram, Durango, Jeep Liberty, 1997on - see picture no 37 |
| 114 | AS15900 | Saginaw Magnasteer - see picture no 59 |
| 115 | AS15901 | Chrysler LHD - see picture no 62 |
| 116 | AS15902 | Silverado - see picture no 60 |
| 117 | AS15903 | Toyota, Lexus - see picture no 37 |
| 123 | AS16109 | Envoy power piston |

SEAL TOOLS

BULKHEAD TOOLS

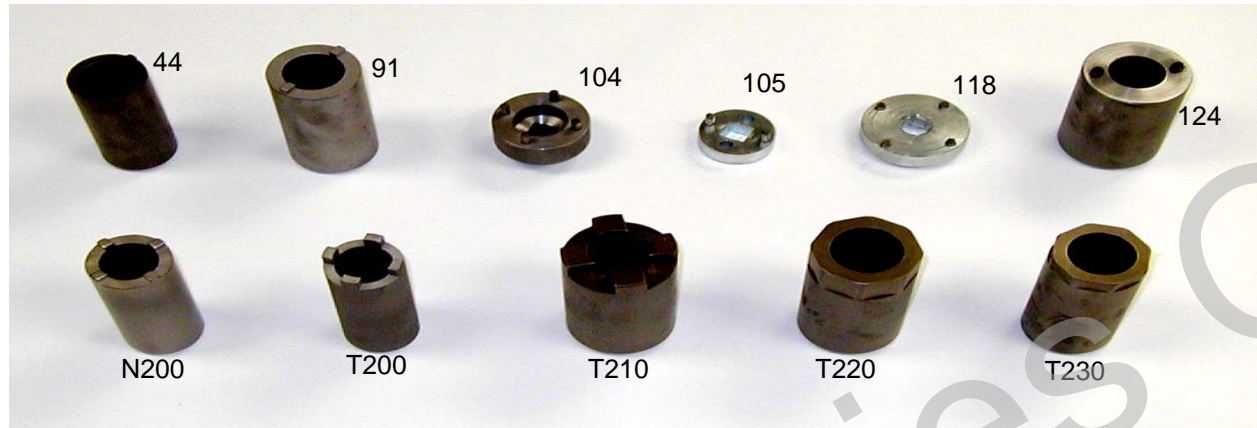

| DIAGRAM NO | AS REF | DESCRIPTION |
|------------|---------|--|
| 44 | AS14261 | TRW, CAM wire stay bulkhead tool |
| 91 | AS14262 | Early CI Ford bulkhead tool, screw type |
| 104 | AS14263 | Late Ford bulkhead tool, screw type |
| 105 | AS14264 | Chrysler LH bulkhead tool |
| N200 | AS14265 | Nissan bulkhead tool |
| T200 | AS16112 | Camry, Avalon, Lexus, Corolla, 1984-88, bulkhead tool |
| T210 | AS14266 | Toyota bulkhead tool |
| T220 | AS14267 | Toyota bulkhead tool |
| T230 | AS14268 | Toyota bulkhead tool |
| 118 | AS15904 | Dodge Ram, Durango, Jeep Liberty, 1997 on - see picture no 104 |
| 124 | AS16113 | No Longer Available |

SEAL INSTALERS

SEAL TOOLS



| DIAGRAM NO | AS REF | DESCRIPTION |
|------------|---------|---|
| 50 | AS14218 | Seal installer, 0.940" I/D - requires handle, item no 21 |
| 69 | AS14219 | Seal installer, 0.980" I/D - requires handle, item no 21 |
| 71 | AS14221 | Seal installer, 1.200" I/D - requires handle, item no 21 |
| 82 | AS14222 | Saginaw lower seal installer, 0.930" I/D |
| 83 | AS14223 | Saginaw lower seal installer, 1.010" I/D |
| 84 | AS14224 | TRW, lower seal installer, 0.880" I/D |
| 85 | AS14225 | Ford, lower seal installer, 0.945" I/D |
| 86 | AS14226 | Ford, lower seal installer, 1.080" I/D |
| 80 | AS14227 | Inner seal installer, Ford, Chrysler, 0.830" I/D |
| 81 | AS14228 | Inner seal installer, Ford, Chrysler 0.930" I/D |
| 106 | AS14230 | Ford lower seal installer, 0.960" I/D |
| 107 | AS14231 | Saginaw outer seal installer |
| 108 | AS14232 | Chrysler, 1994-97, LH, inner seal installer |
| ZF220 | AS14239 | ZF, outer seal installer, 0.820" I/D - requires handle, item no 21 |
| ZF230 | AS14240 | ZF, outer seal installer, 0.965" I/D - requires handle, item no 21 |
| A100 | AS14241 | Audi, 1978-83, inner seal installer - requires handle, item no 21 |
| A220 | AS14242 | Audi, 1984 on, inner seal installer - requires handle, item no 21 |
| 21 | AS14243 | 15" handle |
| 119 | AS15905 | Nissan, ZF, main casting seal installer - replaces AS14233, AS14237 |
| 120 | AS15906 | Nissan, ZF, main seal installer replaces AS14234, 5, 6, 8 |
| 121 | AS15907 | Toyota, Lexus, upper pinion seal installer, 19mm I/D |
| 122 | AS15908 | ZF, upper pinion seal installer, 20mm I/D |
| 20 | AS16110 | 6" handle for pinion seal & bulkhead seal installer |
| 124 | AS16111 | 2 piece main seal installer |

SEAL TOOLS

PINION BEARING TOOLS

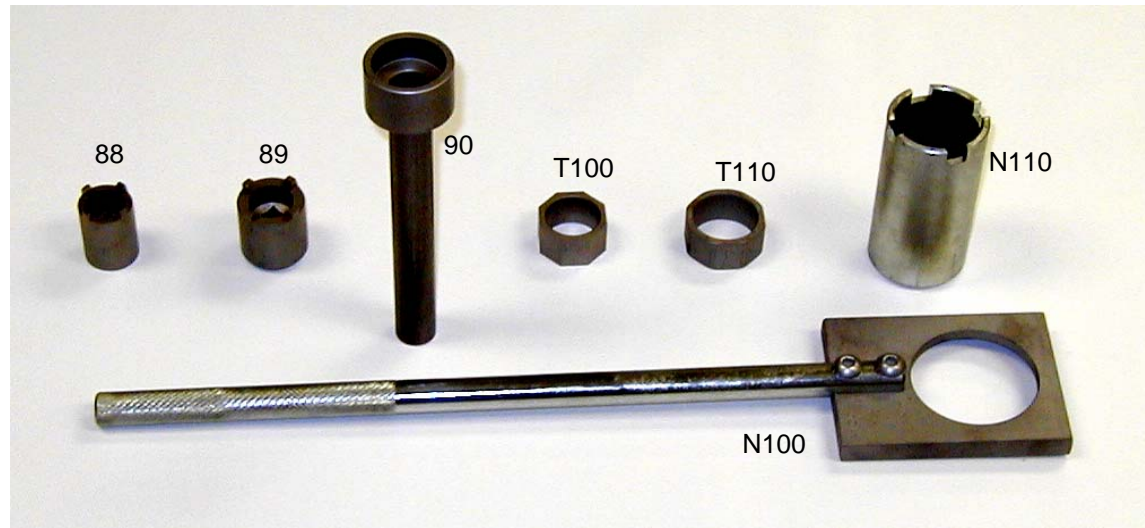

| DIAGRAM NO | AS REF | DESCRIPTION |
|------------|---------|--|
| N100 | AS14254 | Upper pinion tool, large valve Nissan nut |
| N110 | AS14255 | Upper pinion tool, large valve Nissan socket |
| 88 | AS14256 | Lower pinion tool, Renault, VW |
| 89 | AS14257 | Lower pinion tool, Ford, VW, TRW |
| 90 | AS14258 | Lower pinion tool, Saginaw |
| T100 | AS14259 | Pinion nut tool, 1.25", Toyota, Lexus |
| T110 | AS14260 | Pinion nut tool, 1.43", Toyota, Lexus |

OTHER RACK & PINION TOOLS

SEAL TOOLS

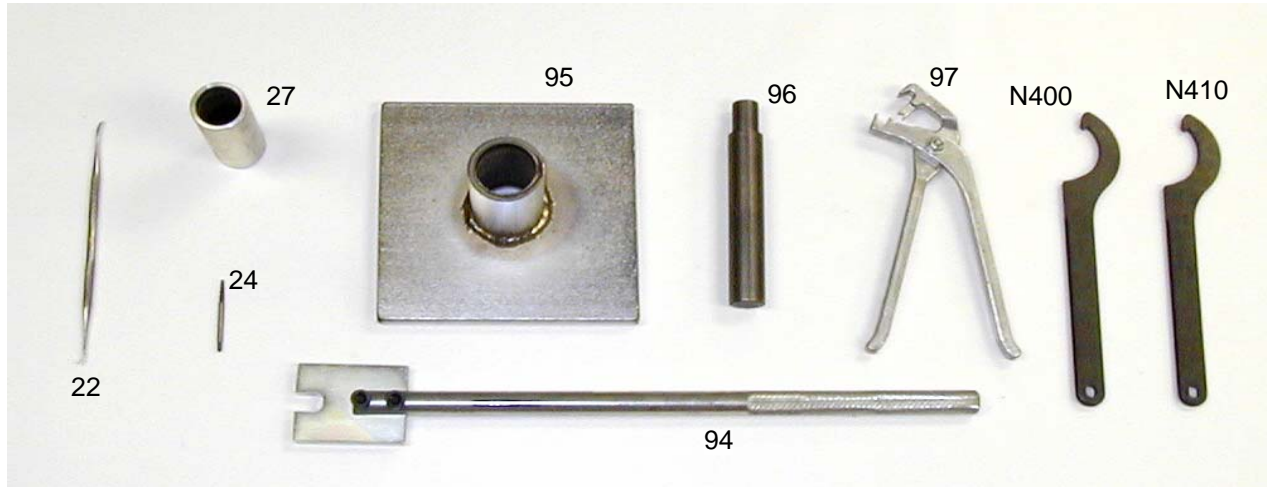

| DIAGRAM NO | AS REF | DESCRIPTION |
|------------|---------|--|
| 22 | AS14284 | Seal pick |
| 24 | AS14285 | Extractor for roll pined locked tie rods |
| 27 | AS14286 | Dust seal installer |
| 94 | AS14287 | No Longer Available |
| 95 | AS14288 | Base plate for removal of Ford mounting bush |
| 96 | AS14289 | Driver for removal of Ford mounting bush |
| 97 | AS14290 | Boot clamp pliers |
| N400 | AS14291 | Nissan casting tool, 50mm |
| N410 | AS14292 | Nissan casting tool, 55mm |

JAM NUT TOOLS

SEAL TOOLS

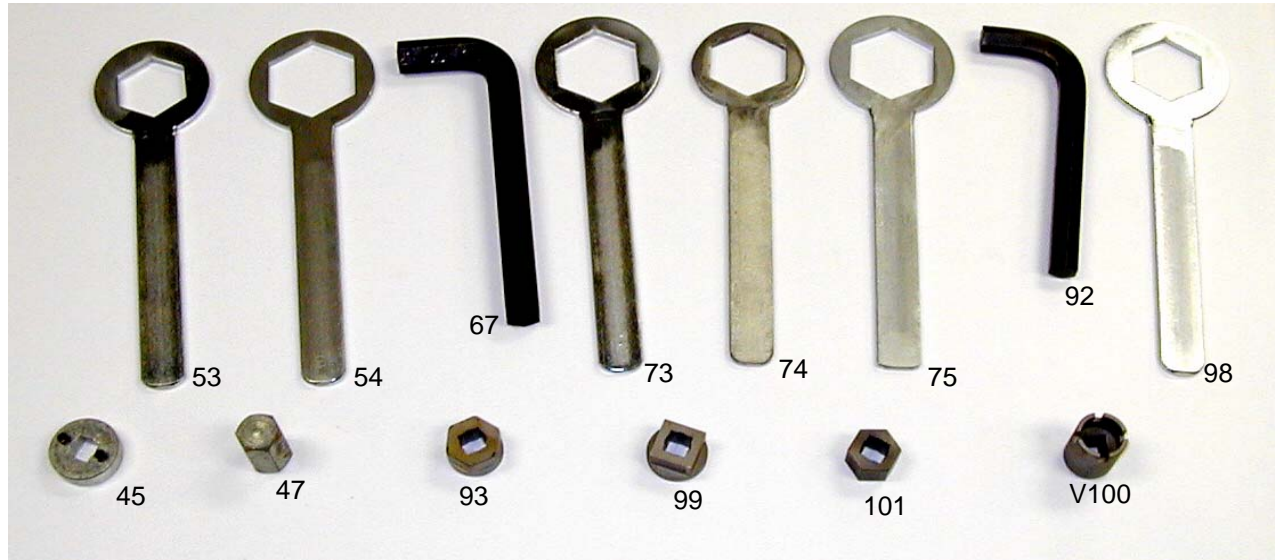

| DIAGRAM NO | AS REF | DESCRIPTION |
|------------|---------|--|
| 45 | AS14269 | Rack jam nut tool, cast iron, Ford |
| 47 | AS14270 | Rack jam nut tool, 7/8" |
| 53 | AS14271 | Lock wrench nut, 1 9/16" |
| 54 | AS14272 | Lock wrench nut, 2" |
| 67 | AS14273 | Rack jam nut tool, 3/4" |
| 73 | AS14274 | Lock nut wrench, 1 3/4" |
| 74 | AS14275 | Lock nut wrench, 1 7/8" |
| 75 | AS14276 | Lock nut wrench, 1 15/16" |
| 92 | AS14277 | Rack jam nut tool, 5/8" |
| V100 | AS14278 | Volvo jam nut tool |
| 93 | AS14279 | Volvo, Chrysler jam nut tool, 1.110" |
| 98 | AS14280 | Lock nut wrench, 43mm |
| 99 | AS14281 | TRW, CAM square jam nut tool, 0.935" |
| 101 | AS14282 | TRW, CAM, Nissan, jam nut tool, 1.035" |